

1

252'
PAR 3

'Hole Shot'

WC Griffith Memorial Disc Golf course

*** Faircrest Park ***



DO NOT EVER THROW IF THERE
ARE OTHER PLAYERS OR PARK
USERS WITHIN YOUR RANGE !!!

YELL 'FORE' ... LOUD ... IF YOUR
SHOT **MIGHT** HIT SOMEONE !!!

WE ARE ALL GUESTS IN THIS PARK
DON'T SPOIL IT FOR OTHERS!

LET FASTER PLAYERS PLAY THRU!

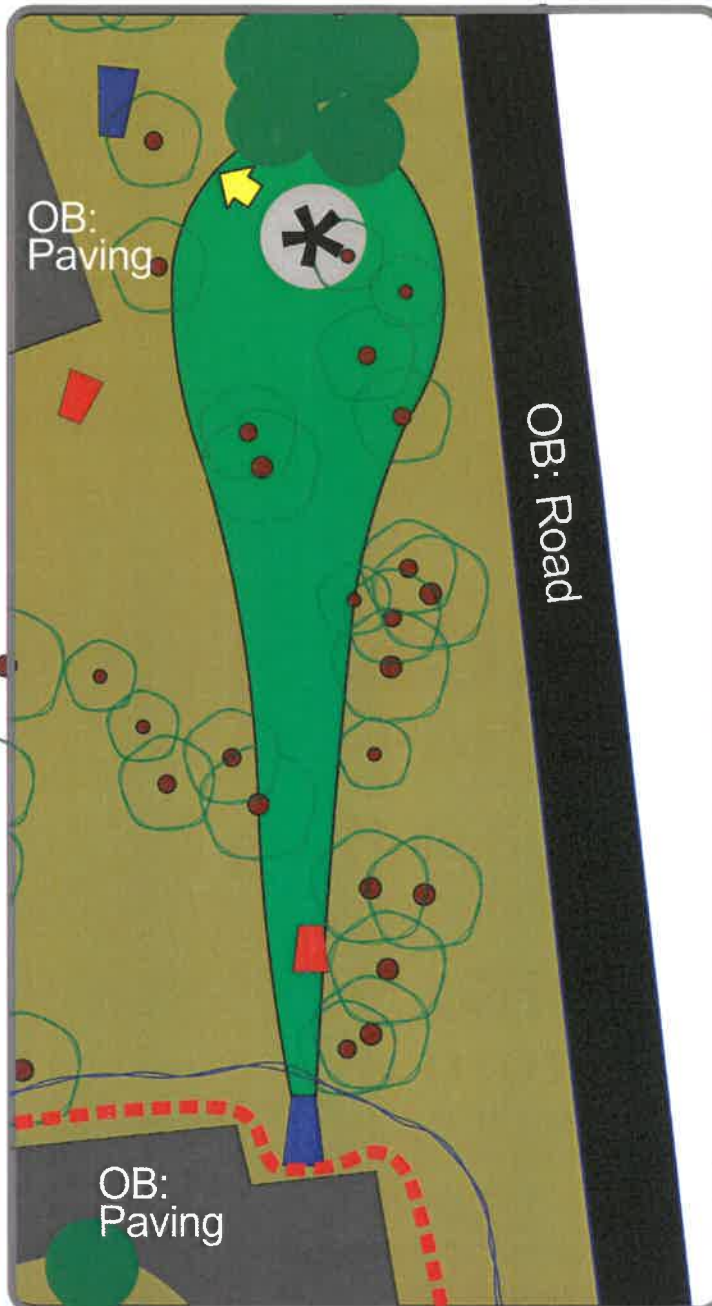

2018 CANTON TOWNSHIP ELECTED OFFICIALS

TRUSTEES

WILLIAM G. MITTAS
MARK R. SHAFFER
CHRISTOPHER B. NICHOLS

FISCAL OFFICER:

RONALD L. SMITH

2

258'
PAR 3

'A Tangled Web'

**WC Griffith
Memorial
Disc Golf course**

* Faircrest Park *



803.02 Teeing Off
...Running up from behind the teeing area before the disc is released is permitted. Following through in front of the teeing area is permitted provided there is no supporting point contact outside the teeing area when the disc is released.

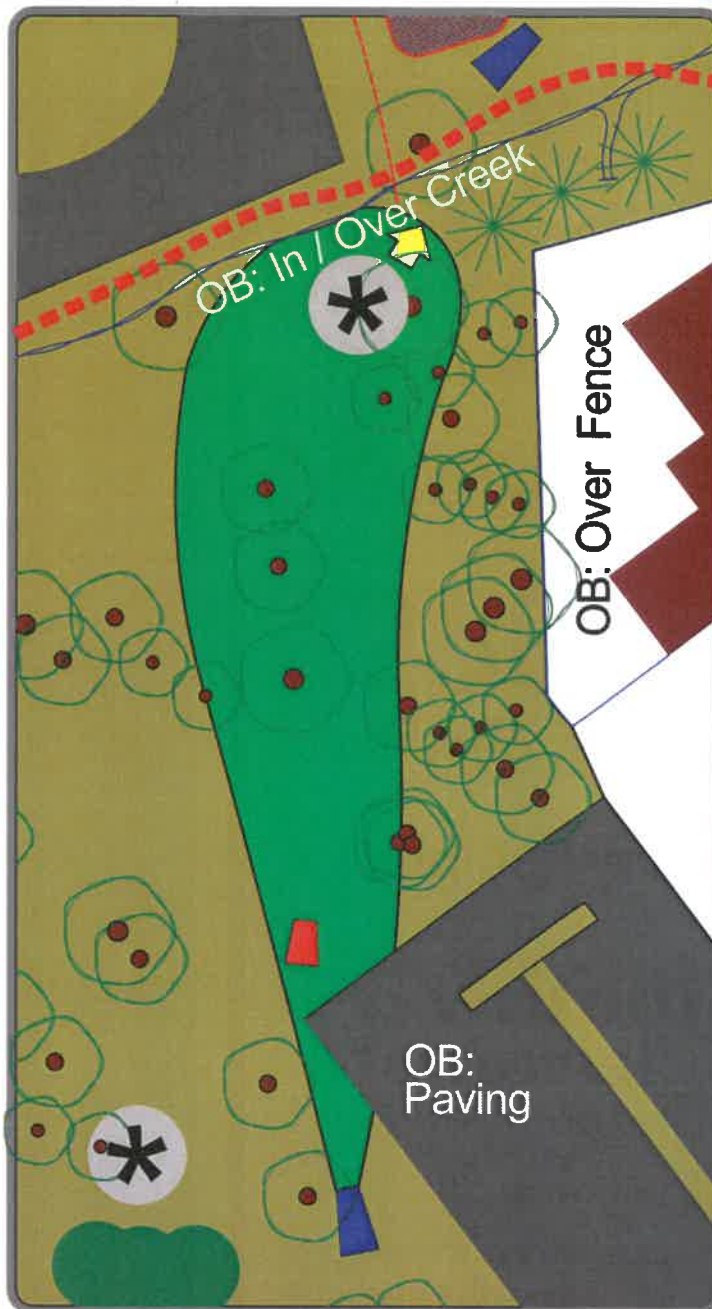

The PIZZA OVEN

**FAMILY OWNED & OPERATED
SINCE 1956**

484-2518

3

312'
PAR 3

'Wills Creek'

WC Griffith
Memorial
Disc Golf course

* Faircrest Park *



803.09 Out-of-Bounds
A disc is considered out-of bounds
when it comes to rest and is clearly
and *completely surrounded* by the out-
of-bounds area... The Player... shall
receive 1 penalty throw. (Play from
where it was last in-bounds or retee if
first shot or from the Drop Zone)

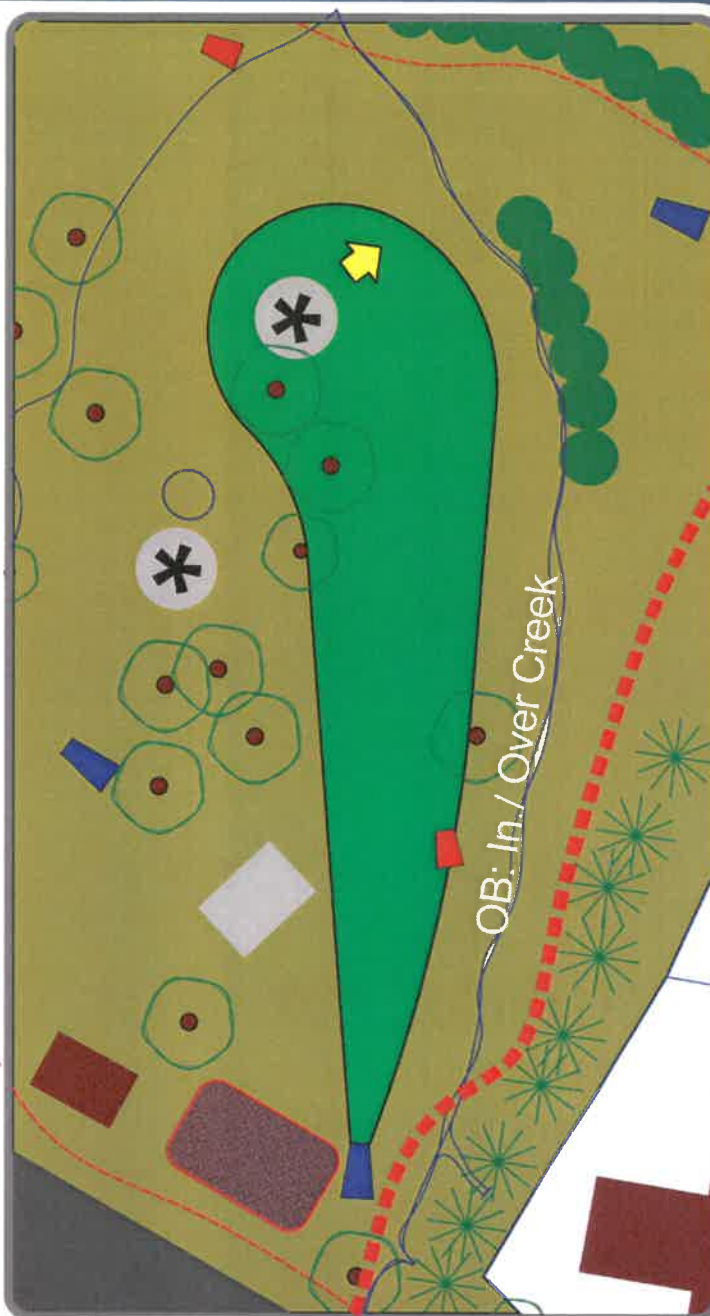

Scott & Edie
**HAMILTON
FOUNDATION**



4

489'
PAR 3

**'The Back
Staightaway'**

**WC Griffith
Memorial
Disc Golf course**

* Faircrest Park *



801.03: Excessive Time
A maximum of 30 seconds is allowed to each player to make a throw after the previous player has thrown, the player has arrived at the disc, and the playing area is clear... First time is a warning, subsequent times in the same round is one penalty throw.

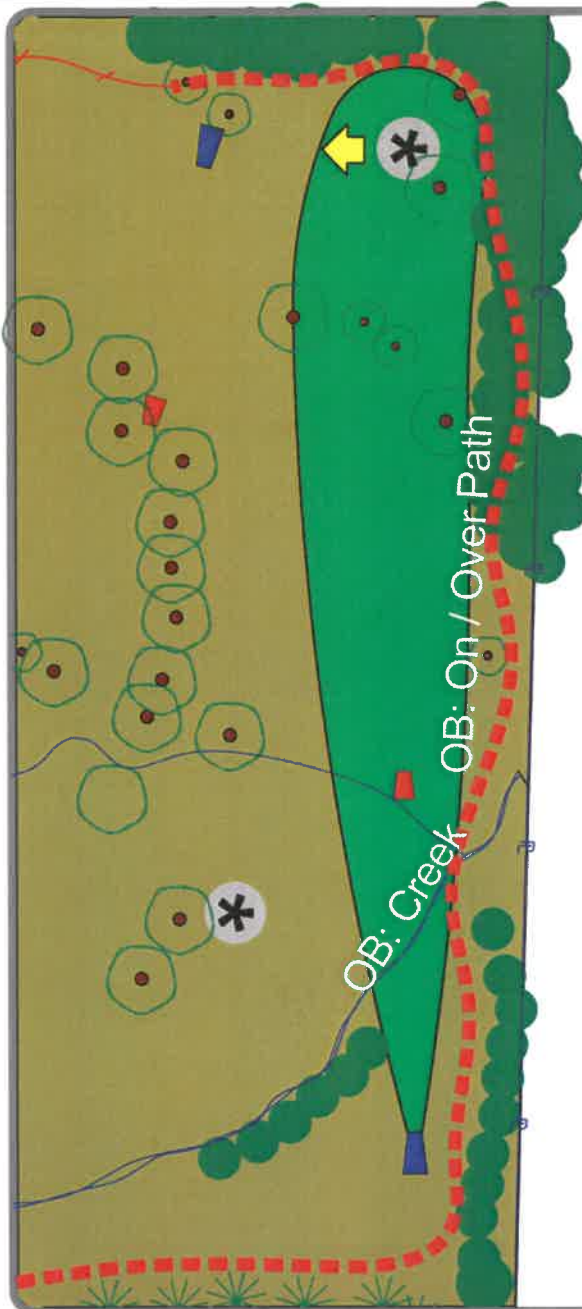

5

402'
PAR 3

'The American
Dream'

WC Griffith
Memorial
Disc Golf course

* Faircrest Park *



893.04.C Stance:
Any throw from within 10 meters
(32'-6") or less is considered a putt.
A follow through after the putt that
causes the thrower to make any
supporting point closer to the hole
than the rear edge of the marker disc
constitutes a falling putt & is a stance
violation.

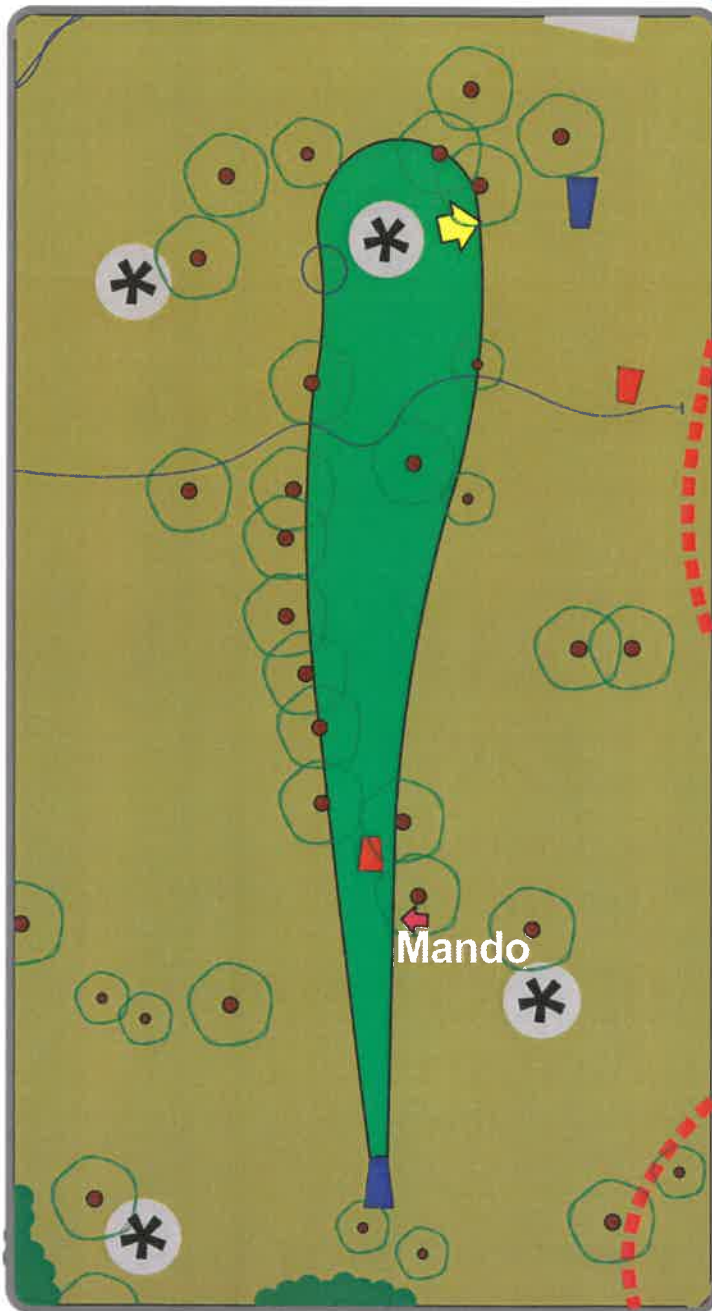

WACO MARKET

Home of Wild Bill's

Pizza & Chicken

1660 Waynesburg Dr. SE, Canton

6

312'
PAR 3

'Brothers Drive'

**WC Griffith
Memorial
Disc Golf course**

* Faircrest Park *



803.11: Lost Disc - Part A
... A disc shall be declared lost if the player cannot locate it within three minutes after arriving at the spot where it was last seen... Someone must note when timing begins... All players in the group must assist in searching for the disc the full 3 minutes...

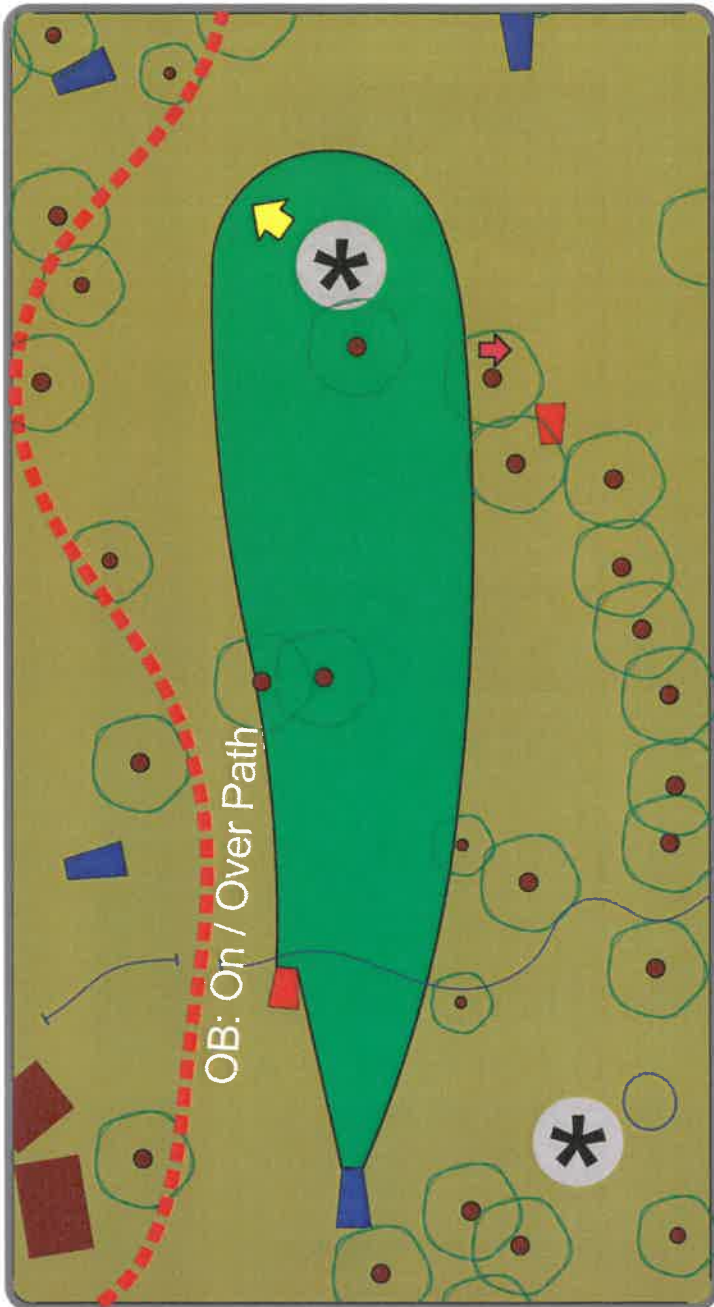

Milhoan Asphalt Inc.
**Paving, Sealcoating, Stripping
and Asphalt Repairs**

PO Box 293 East Sparta, OH 44626
Phone (330) 802-0233
milhoanasphalt@hotmail.com

7

390'
PAR 3

'Willa's Walk'

**WC Griffith
Memorial
Disc Golf course**

* Faircrest Park *



801.11: Lost Disc - Part B
... If thrown from the tee, the player will retee... Otherwise, the group will determine the approximate lie from which the throw was made and the player will rethrow from that spot... The original throw plus one penalty throw shall be counted...

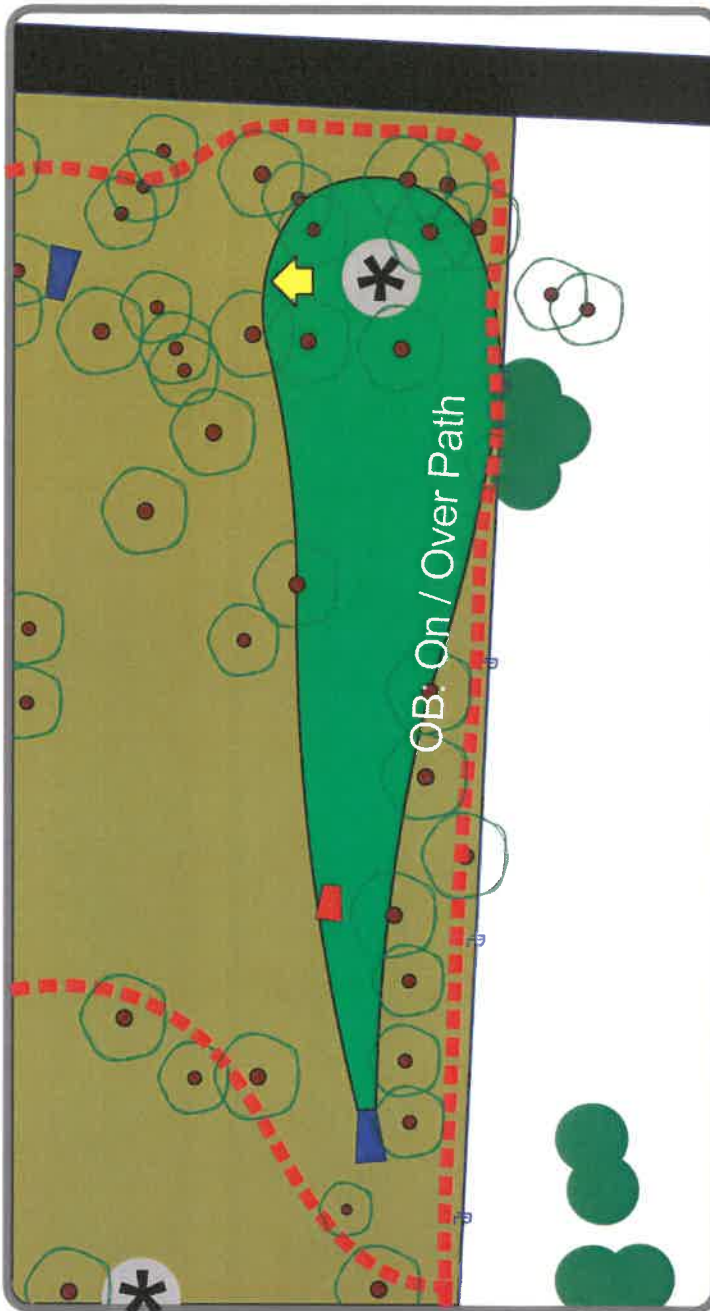

8

261'

PAR 3

'The Sprint'

**WC Griffith
Memorial
Disc Golf course**

* Faircrest Park *



803.06.A Unplayable Lie:
A Player may declare his or her lie to be an unplayable lie... the new lie is relocated... no closer to the hole on the line of play within 5 meters of the unplayable lie... The original throw plus 1 penalty throw are counted in the Players score.



Oldest Name in the Septic Business

Grandsons of W.C. Griffith

D.Griffith & Sons Inc.

Oil & Gas	Septic/Sewer Systems	Design Plans
Land Clearing	Installation & Repairs	Septic Inspections
Hauling/Excavation	Basement Excavation	Driveway Installation

330-488-2832

Dennis, Michael, and Daniel Griffith

BBB Member - Licensed & Insured

9

306'
PAR 3

'The Final Lap'

**WC Griffith
Memorial**
Disc Golf course

* Faircrest Park *



803.08: Optional Rethrow
... At any time, a player may elect to rethrow from the previous lie as evidenced by the marker disc or... from a lie agreed upon by the group or official. The original throw plus one penalty throw are counted to the players score.

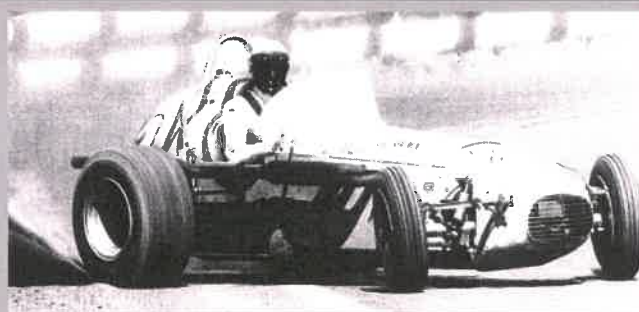
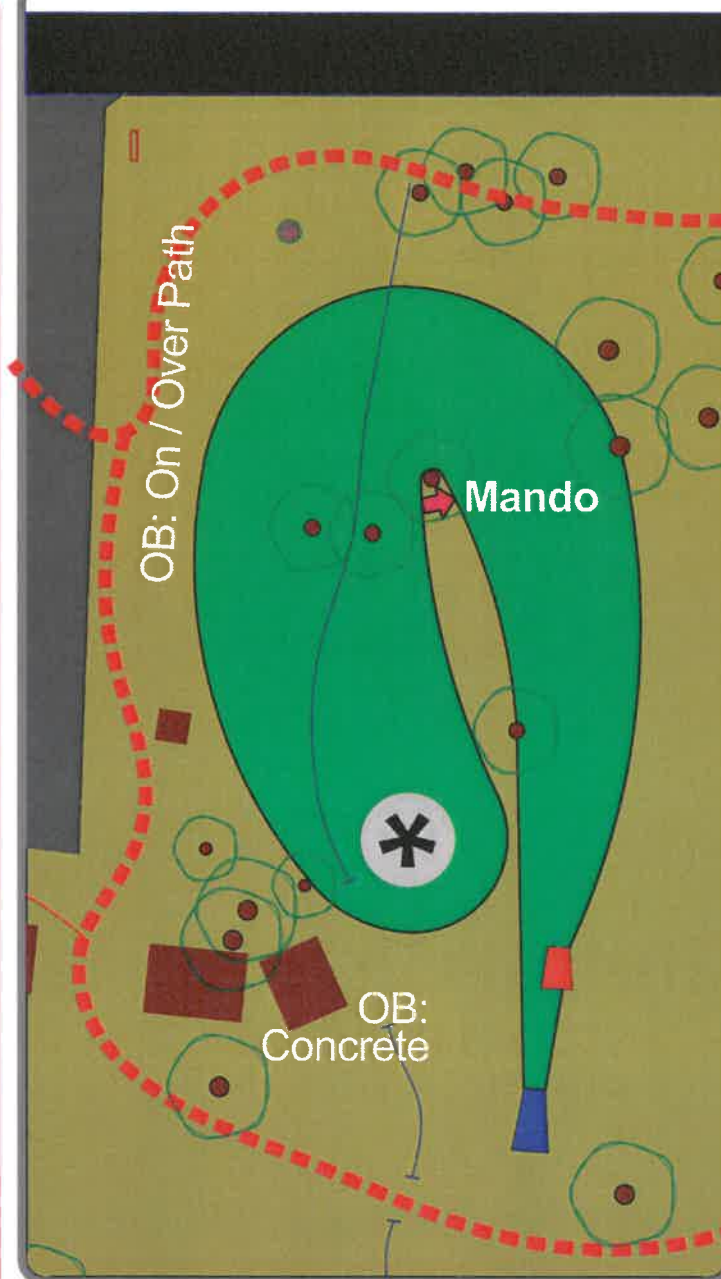

Sponsored by the
**W.C. Griffith
Sons & Family**